

	Test	CCT (K)	Lumen (lm)	P (W)	
ECOLINK EM WALL EXIT SLIM UP 3HR MANUAL	manual	6500	10	<4W	0.646
ECOLINK LEGEND EM WALL EXIT SLIM LEFT					
ECOLINK LEGEND EM WALL EXIT SLIM RIGHT					
ECOLINK LEGEND EM WALL EXIT SLIM DOWN					

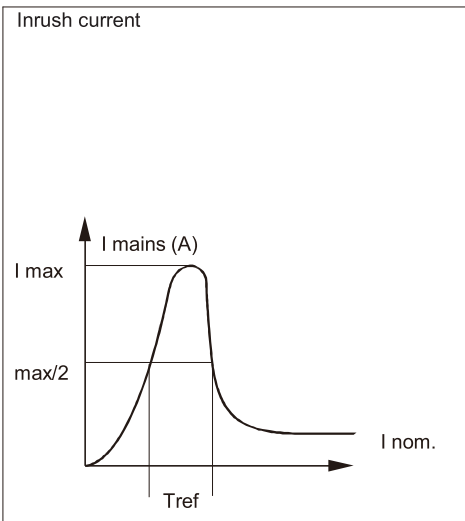
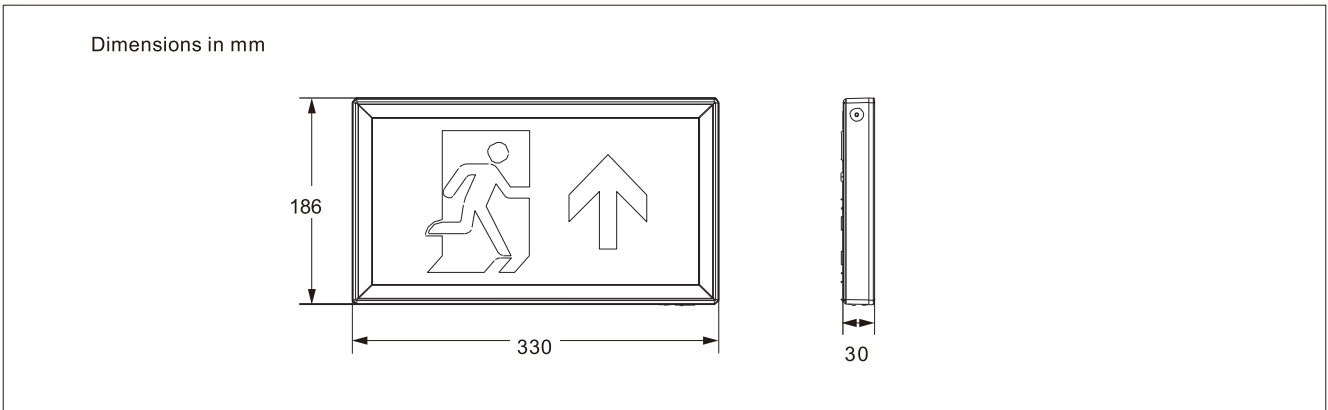

Electrical characteristics	
Inom (mA)	0.039
I <sub>max</sub> (A)	6.8
T <sub>ref</sub> (μs)	15
Luminaires	
MCB	Max.
B-10 A	125
B-13 A	163
B-16 A	201
C-10 A	179
C-13 A	233
C-16 A	287

**ATTENTION**  
OBSERVE PRECAUTIONS  
FOR HANDLING  
ELECTROSTATIC  
SENSITIVE  
DEVICES

- The luminaire shall be installed by a qualified elec. electrical regulations or the national requirements.
- When the light source reaches its end of life the whole luminaire shall be replaced.
- Clean with dry cloth.

indicated drivers are used.

ALWAYS SWITCH OFF THE MAINS SUPPLY BEFORE INSTALLATION OR SERVICING

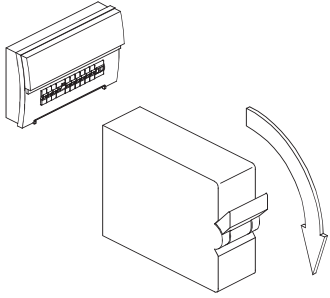

1

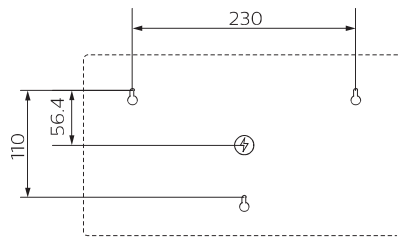

2

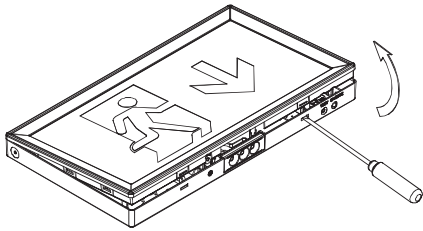
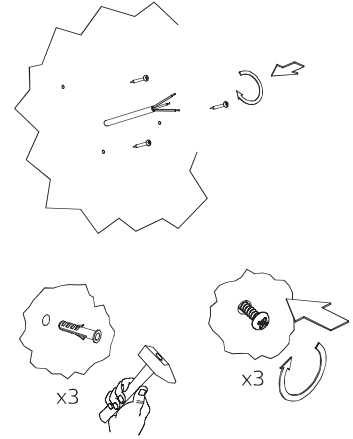

As there's no screw fixing for front cover but clip-on, could be no need torque value

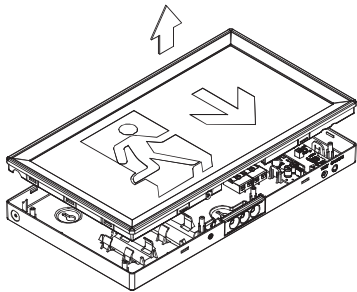

3

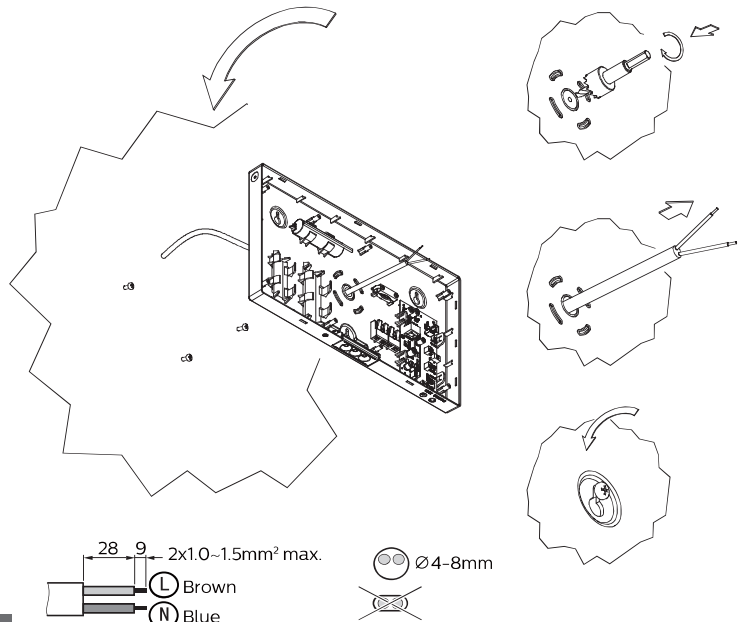

4

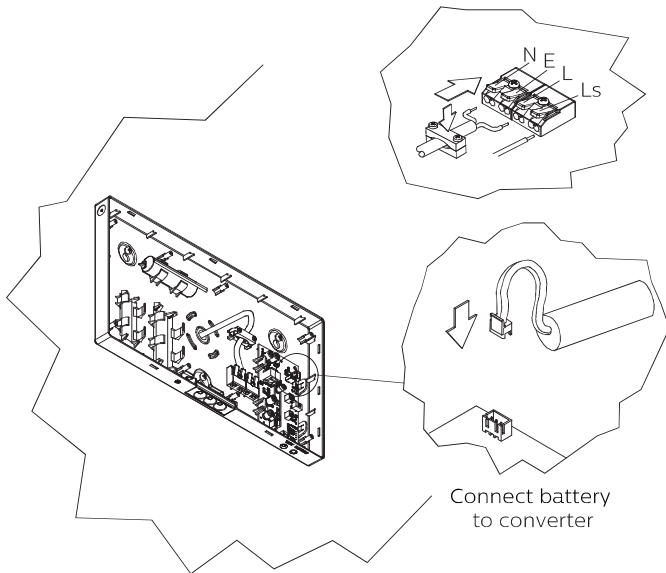

Connect battery to converter

5

### EMERGENCY TERMINATIONS

#### LUMINAIRE

Brown (Ls) —  
Brown (L) —  
(E) —  
Blue (N) —

#### MAINS SUPPLY

SWITCHED SUPPLY  
UNSWITCHED SUPPLY  
For continuity of termination of CPC  
NEUTRAL

#### Duration

on		8H	3H	3H	1H
1	off	off	on	on	
2	off	on	off	on	

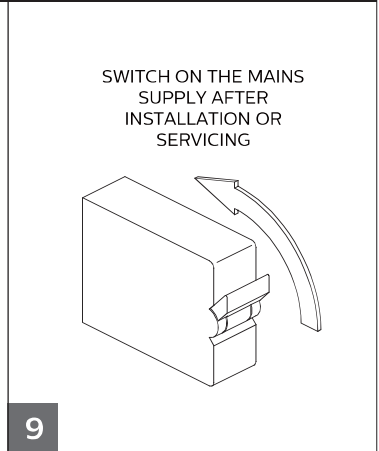
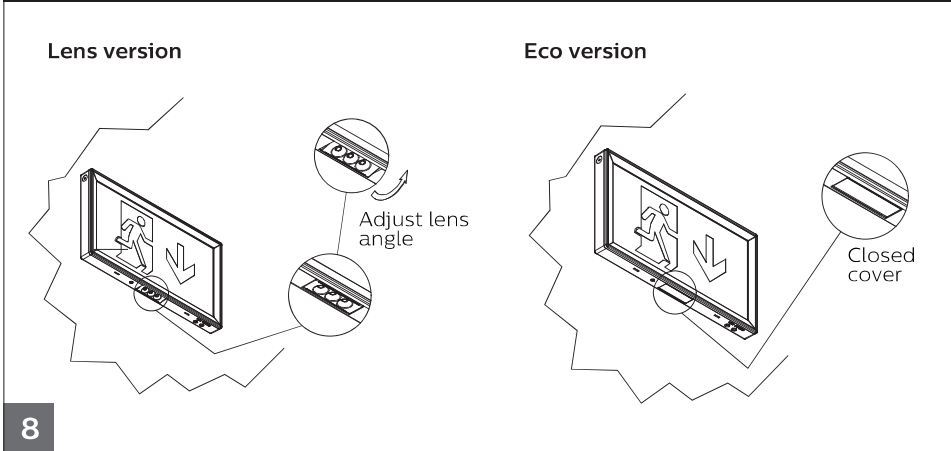
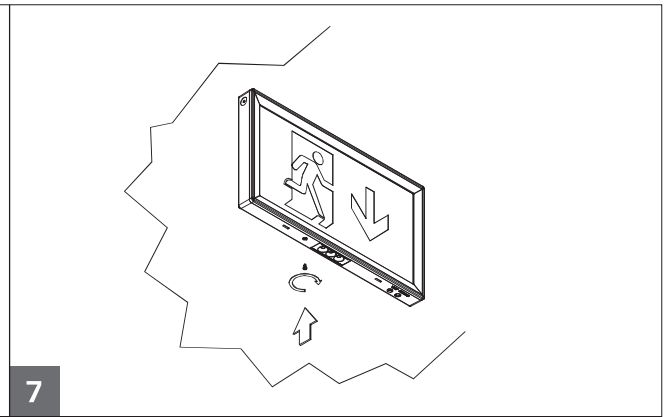
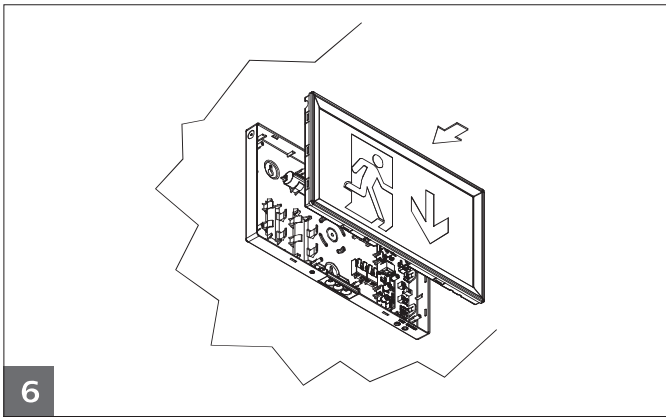

## Pictogram Replacement

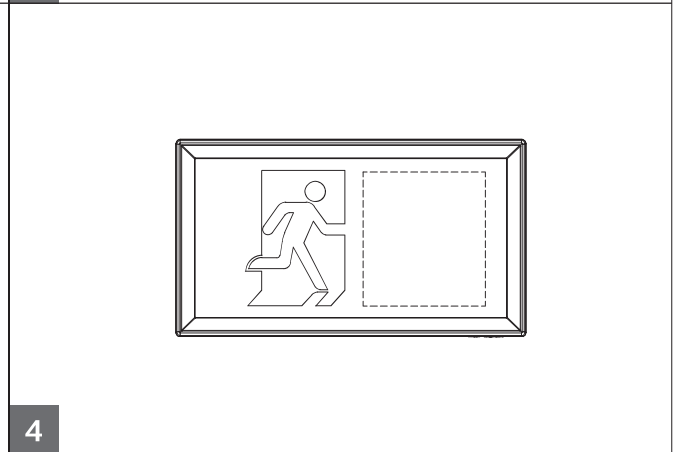
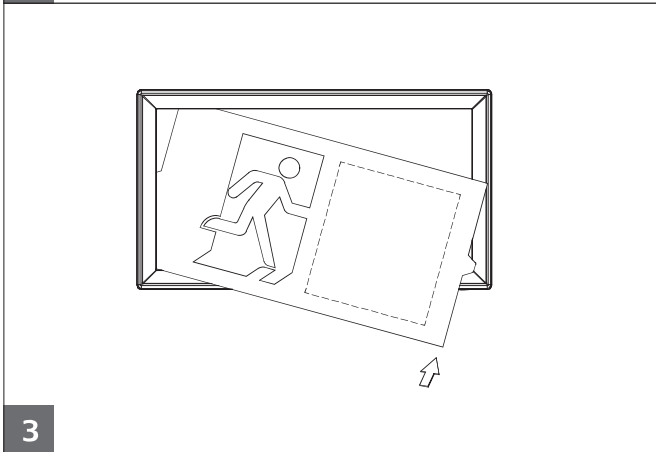
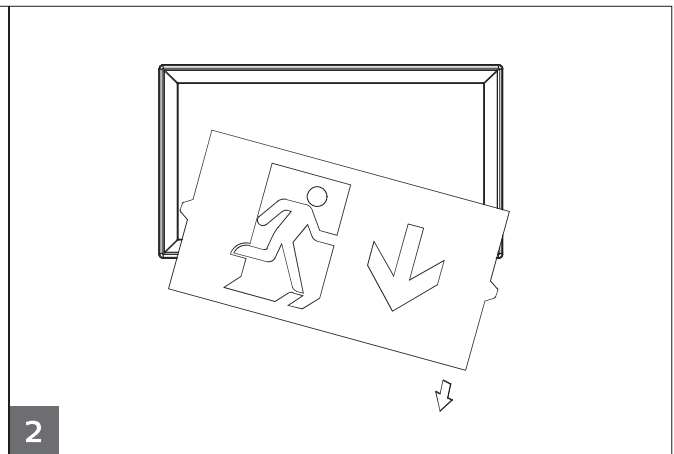
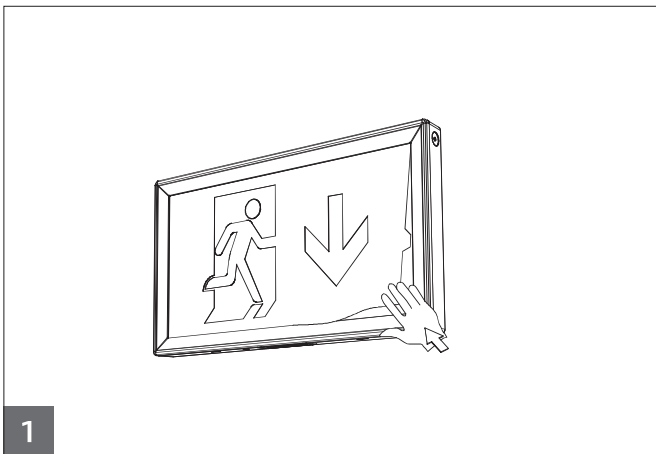

### Battery replacement

LiFePO<sub>4</sub> -18650-1500mAh-3.2V

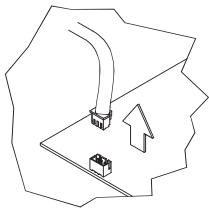

Disconnect battery to converter

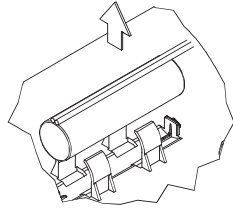

Remove the battery

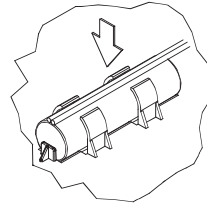

Replace the battery

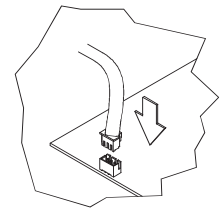

Connect battery to converter

### Luminous Intensity Distribution

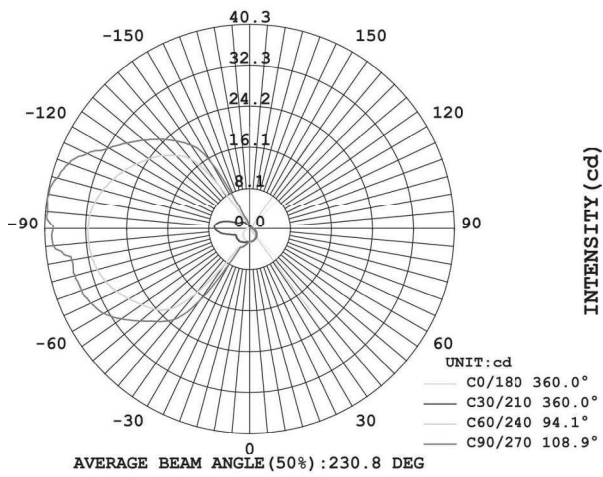

### Viewing Distance

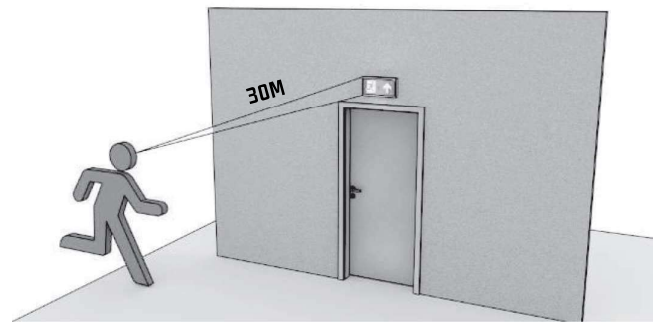



1. For indoor use only.
2. The luminaire complies with IEC60598-1/IEC 60598-2-22.  
The luminaire must be installed by a qualified electrician and wired in accordance with the latest IEE Electrical regulations or the national requirements.
3. Turn off the power supply before checking, installation, maintenance or moving.
4. Do not switch on before complete installation.
5. Batteries shall only be replaced by the manufacturer or his service agent or a similar qualified person.
6. Batteries should be replaced when the luminaire no longer meets the 3 hours duration performance.
7. Product mains surge immunity is 0.5/1KV (diff. / comm. mode). To prevent excessive currents and voltages from damaging the device, make sure that the power supply input is equipped with additional protection devices such as surge protectors. For any questions regarding the product's surge protection, please consult the manufacturer's professional.



Please inform yourself about the local waste disposal, separation and collection system for electrical and electronic products and packaging. Please act according to your local rules and do not dispose your old product and packaging with your normal household waste. The correct disposal of the packaging, your product and/or batteries will help prevent potential negative consequences for the environment and human health. Batteries should be disposed separately from the municipal waste stream via designated collection facilities. When disposing a product that contains non-user replaceable batteries, the non-user replaceable batteries shall be removed by a professional.

**Testing Record**

Product: \_\_\_\_\_ Location: \_\_\_\_\_ Installation Date: \_\_\_\_\_

Month	Functional/Duration	Year 1	Year 2	Year 3	Year 4	Year 5
1						
2						
3						
4						
5						
6						
7						
8						
9						
10						
11						
12						